

# StyleView SV31 & SV32 Accessory, CPU Holder

[www.ergotron.com](http://www.ergotron.com)  
 USA 1-800-888-8458  
 Europe +31 (0)33-45 45 600  
 China 86-769-86018920

**ASSEMBLY INSTRUCTIONS**, StyleView SV31 & 32 Accessory, CPU Holder  
**Instrucciones de instalación**, Accesorio StyleView SV31 y 32, Soporte para CPU  
**Notice d'assemblage**, Accessoire StyleView SV31 et 32, Support d'unité centrale  
**Montageanleitungen**, Zubehör für StyleView SV31 und 32, CPU-Halter  
**Installatie instructies**, Accessoire StyleView SV31 & 32, CPU-houder  
**Manuali d'Istruzione**, Accessorio StyleView SV31 e 32, Supporto per CPU  
 取扱説明書, スタイルビュー-SV31&32アクセサリ, CPUホルダー  
 安装说明, StyleView SV31 & 32 附件, CPU固定座  
 설치 안내, StyleView SV31 및 32 부속품, CPU 홀더

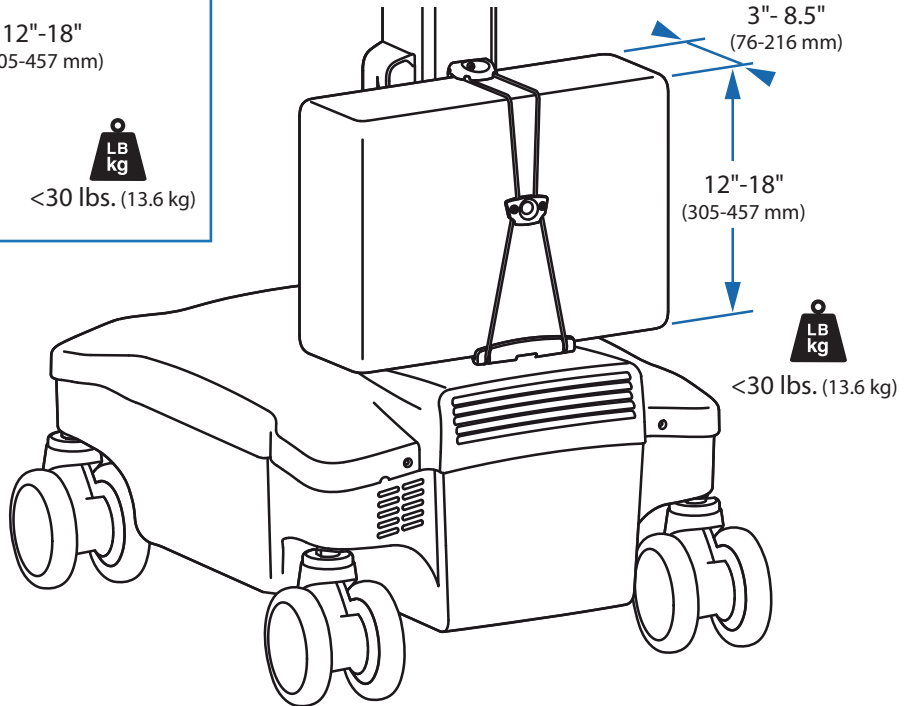
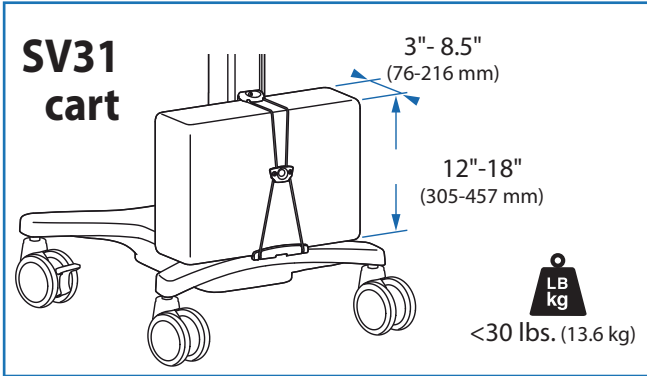

	A	B	C
1	<b>1x</b> 	<b>1x</b> <p>M5 x 18mm Security Screw Tornillo de seguridad Vis de sécurité Sicherheitsschraube mit Innenfünfkant Veiligheidssleutel Vite di sicurezza 固定ネジ 安全螺丝 Security Screw(안전 스크루)</p>	<b>1x</b> <p>5-sided Security Wrench Llave de seguridad pentagonal Clef Allen de sécurité Fünfkant-Inbusschlüssel 5-kantige veiligheidsleutel Chiave pentagonale di sicurezza 5角固定用レンチ 5角安全扳手 5면 Security Wrench(안전 렌치)</p>
2	<b>2x</b> 	<b>1x</b> 	<b>1x</b> 
3	<b>4x</b> 		<b>1x</b> <p>3mm</p>

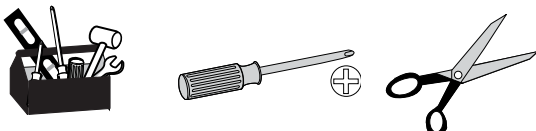

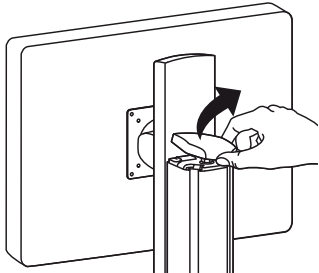
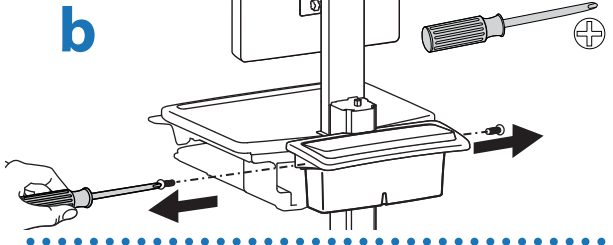
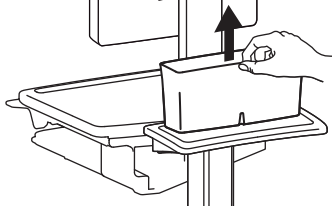
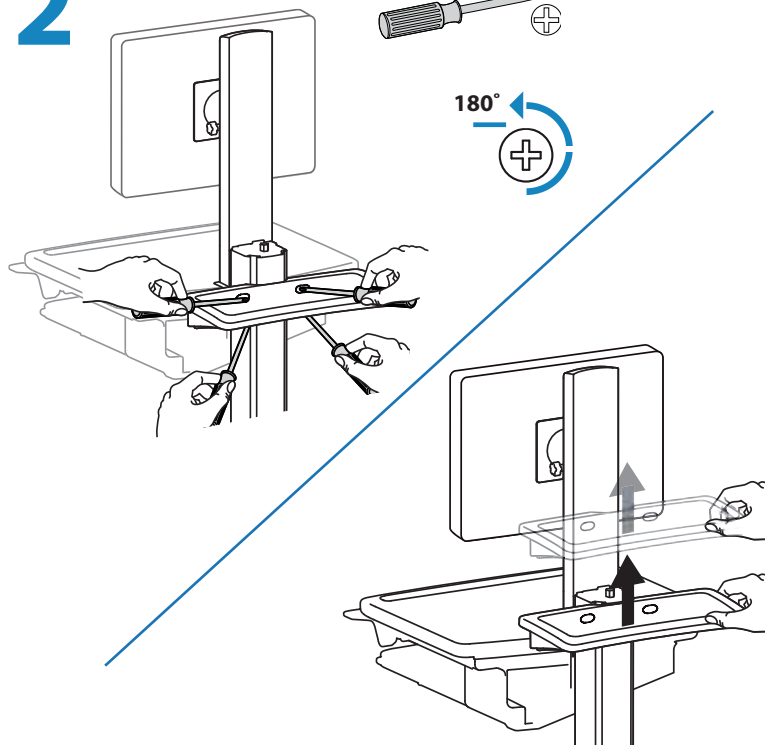
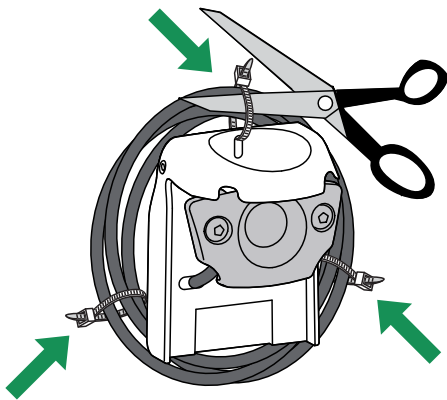
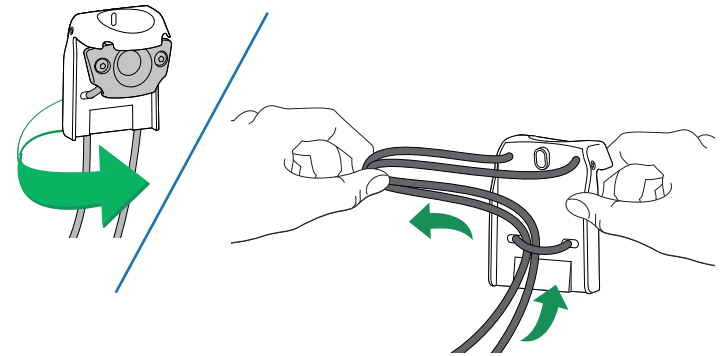
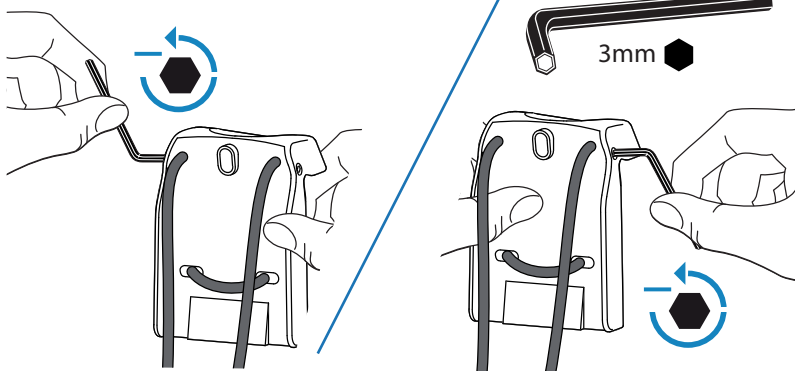
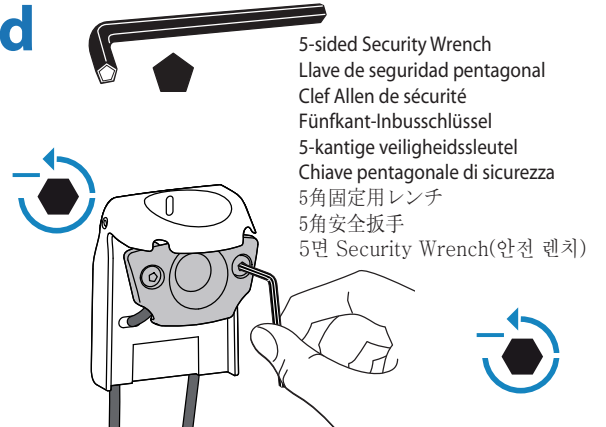
**1 a****b****c****2****3 a****b****c****d**

5-sided Security Wrench  
 Llave de seguridad pentagonal  
 Clef Allen de sécurité  
 Fünfkant-Inbusschlüssel  
 5-kantige veiligheidsleutel  
 Chiave pentagonale di sicurezza  
 5角固定用レンチ  
 5角安全扳手  
 5면 Security Wrench(안전 렌치)

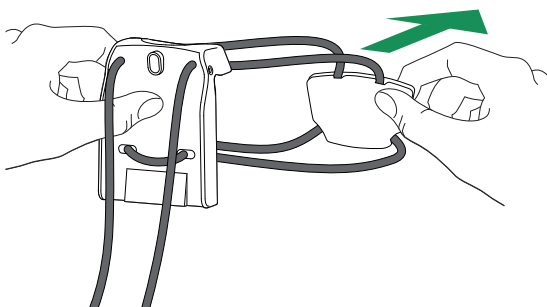
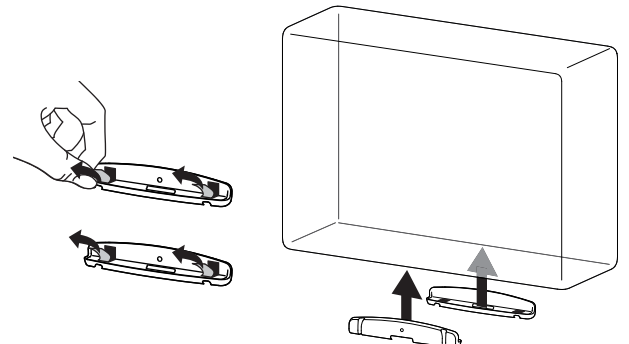
**e****f**

# 4 a

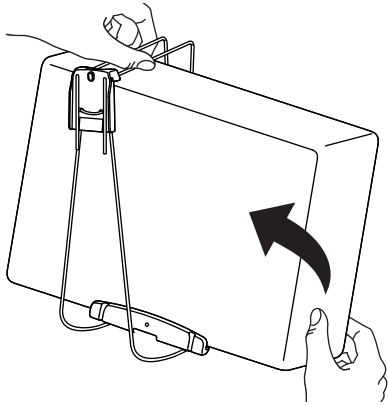

# b

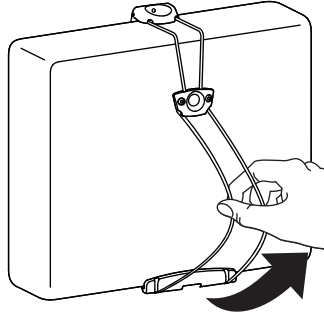

# c

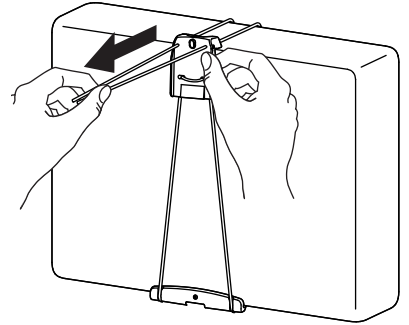

# d

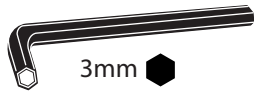

3mm

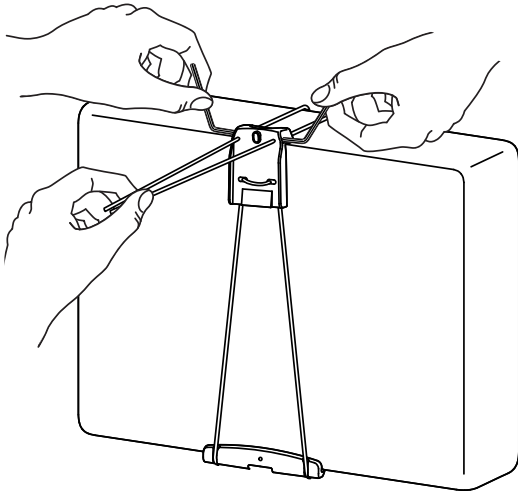

Caution: Do Not over tighten fasteners. Over-tightening may cause damage to fasteners.  
 Precaución: No apriete demasiado los sujetadores. Hacerlo podría dañarlos.  
 Attention: Ne Pas serrer excessivement les fixations. Risques d'endommagement en cas de serrage excessif.  
 Vorsicht: Die Halterungen niemals übermäßig festziehen. Das übermäßige Festziehen kann die Halterungen beschädigen.  
 Let op: Draai de bevestigingsmaterialen niet te vast. Te vast aandraaien kan schade veroorzaken aan de bevestigingsmaterialen.  
 Attenzione: Non serrare eccessivamente i dispositivi di fissaggio. Ciò potrebbe causare danni agli elementi di fissaggio.  
 注意: 留金は締めすぎないようにしてください。強く締め付けすぎると、金具が破損する原因となります。  
 小心: 不要过度拧紧紧固件。过度拧紧可能会损坏紧固件。  
 주의: 패스너를 너무 조이지 않도록 하십시오. 너무 조이면 패스너에 손상이 발생할 수 있습니다.

# e

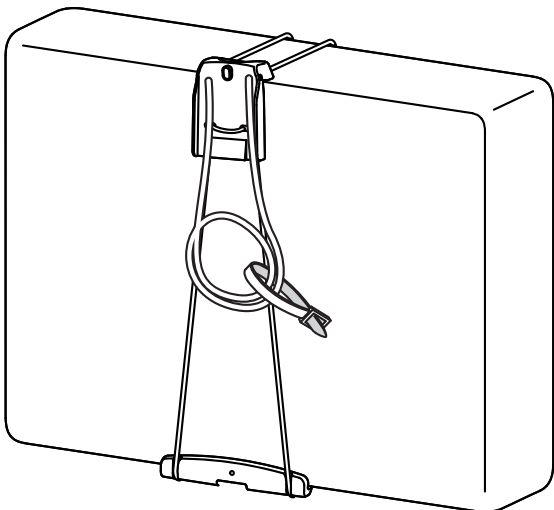
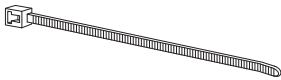

# f

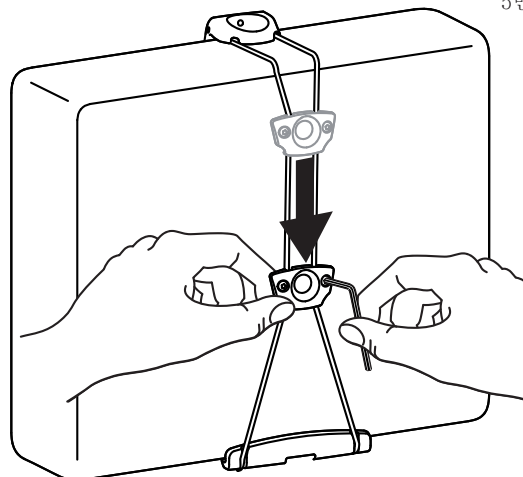

5-sided Security Wrench  
 Llave de seguridad pentagonal  
 Clef Allen de sécurité  
 Fünfkant-Inbusschlüssel  
 5-kantige veiligheidsleutel  
 Chiave pentagonale di sicurezza  
 5角固定用レンチ  
 5角安全扳手  
 5면 Security Wrench(안전 렌치)

# 5 a

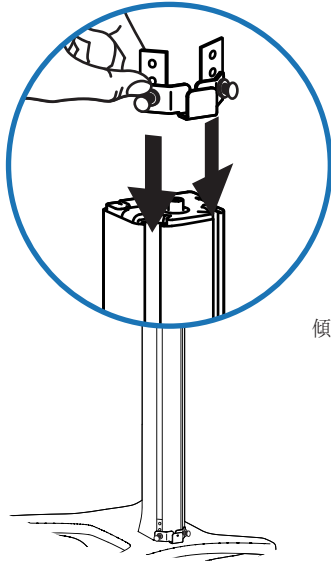
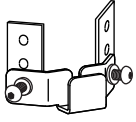

NOTE: Position at bottom of tower. Do not tighten at this time.  
 NOTA: Colóquelo en el extremo inferior de la torre. No lo apriete en este momento.  
 REMARQUE : Positionner en bas de la tour. Ne pas serrer encore.  
 HINWEIS: An der Unterseite des Turms positionieren. Noch nicht festziehen.  
 OPMERKING: Plaats onderaan de toren. Zet nog niet vast.

NOTA: Posizionarlo nella parte inferiore della torre. Non serrare ancora.  
 傾く危険性: ブラケットの位置は、CPUがタワーのできるだけ低い位置に来るようにします。  
 倾覆危险: 固定托架, 以将主机安装在支柱尽可能低的位置。  
 넘어질 위험: 브래킷을 위치시켜 CPU를 타워에 가급적이면 낮게 장착합니다.

# b

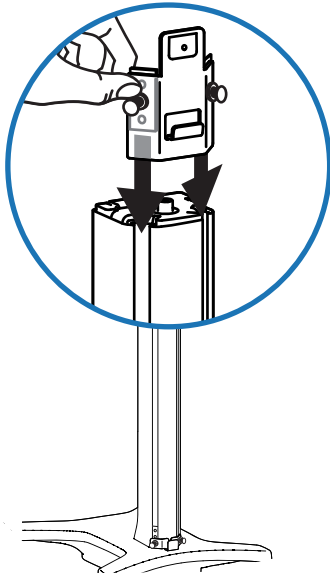
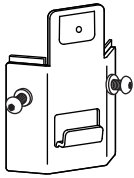

# c

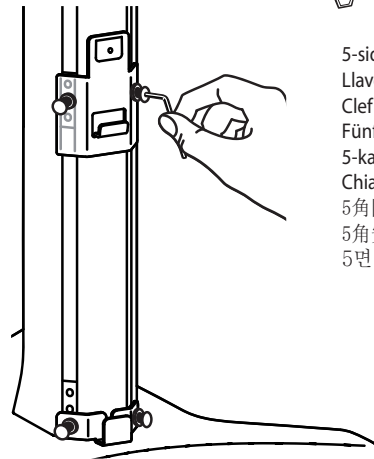

5-sided Security Wrench  
 Llave de seguridad pentagonal  
 Clef Allen de sécurité  
 Fünfkant-Inbusschlüssel  
 5-kantige veiligheidssleutel  
 Chiave pentagonale di sicurezza  
 5角固定用レンチ  
 5角安全扳手  
 5면 Security Wrench(안전 렌치)

# d

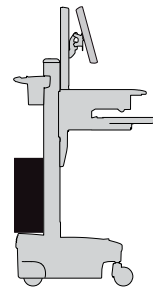
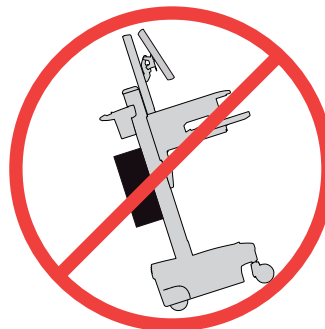
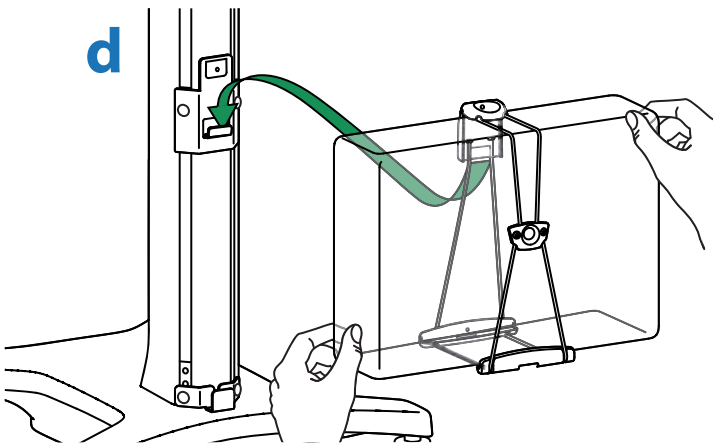

Tipping Hazard: Position bracket so that CPU attaches at the bottom of the tower.  
 Riesgo de vuelco: Coloque el soporte de modo que la CPU quede colocada lo más bajo posible en la torre.  
 Risque de renversement : Positionner le collier pour que l'unité soit positionnée aussi bas que possible sur la tour.  
 Kippgefahr: Die Halterung so positionieren, dass die CPU so weit unten wie möglich am Turm befestigt ist.  
 Omkantelgevaar: Plaats de beugel zo, dat de CPU zo laag mogelijk op de toren vast komt te zitten.  
 Rischio di ribaltamento: Posizionare la staffa in modo tale che la CPU venga posizionata nel punto più basso possibile sulla torre.

注: タワーの底辺に位置させます。この時点ではまだ締めないでください。

注意: 位于支柱的底部。这时候不要拧紧。

주: 타워의 하단에 위치시킵니다. 이제는 조이지 마십시오.

# 6 a 1x

M5 x 18mm  
Security Screw  
Tornillo de seguridad  
Vis de sécurité  
Sicherheitschraube mit Innenfünfkant  
Veiligheidsleutel  
Vite di sicurezza  
固定ネジ  
安全螺丝  
Security Screw(안전 스크루)



5-sided Security Wrench  
Llave de seguridad pentagonal  
Clef Allen de sécurité  
Fünfkant-Inbusschlüssel  
5-kantige veiligheidsleutel  
Chiave pentagonale di sicurezza  
5角固定用レンチ  
5角安全扳手  
5면 Security Wrench(안전 렌치)

# b

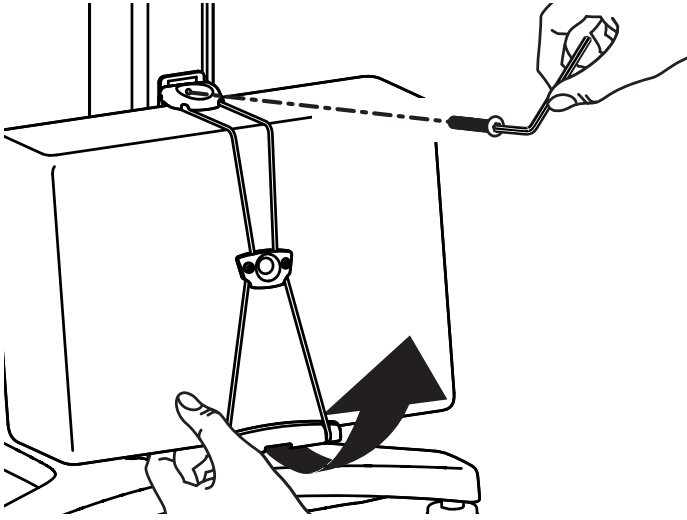
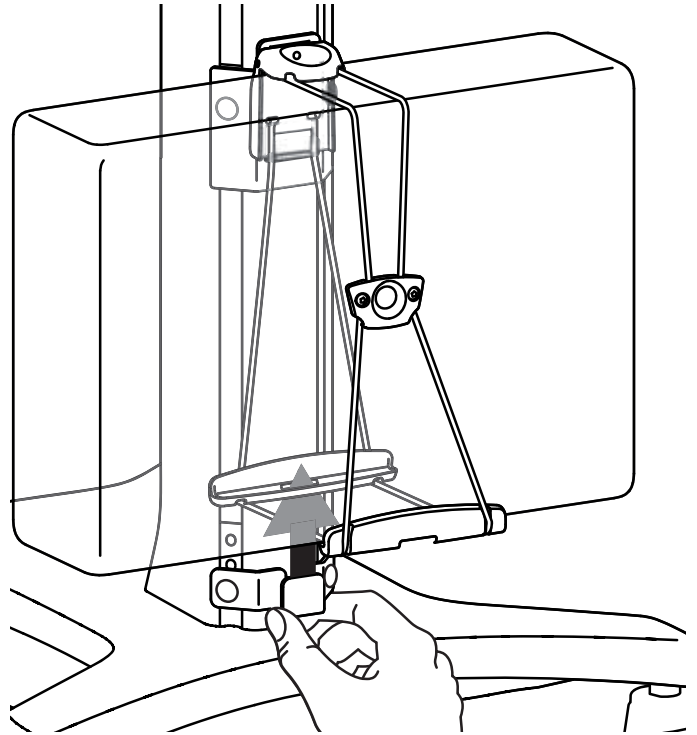

# c

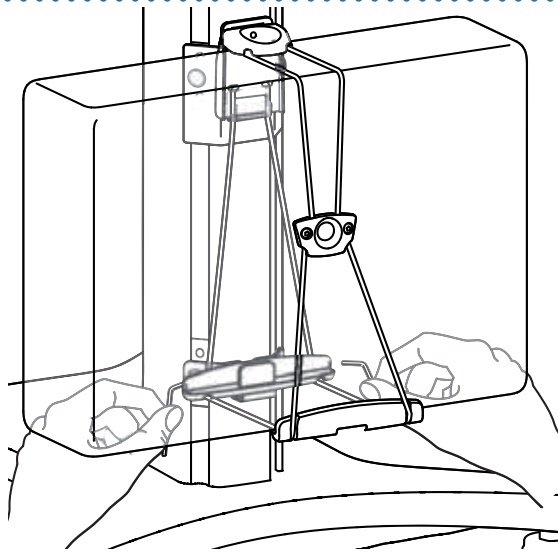

5-sided Security Wrench  
Llave de seguridad pentagonal  
Clef Allen de sécurité  
Fünfkant-Inbusschlüssel  
5-kantige veiligheidsleutel  
Chiave pentagonale di sicurezza  
5角固定用レンチ  
5角安全扳手  
5면 Security Wrench(안전 렌치)

# d

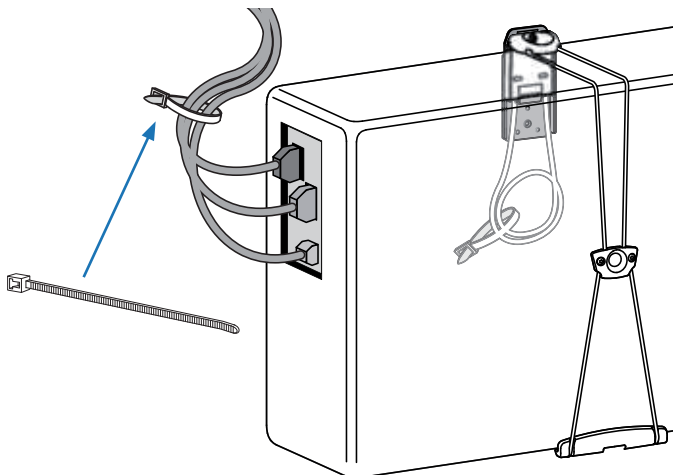

# 7 a

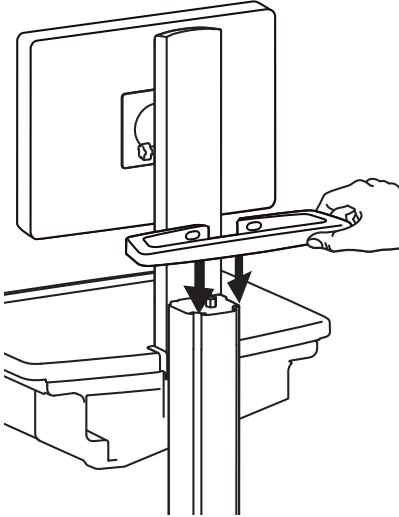

# b

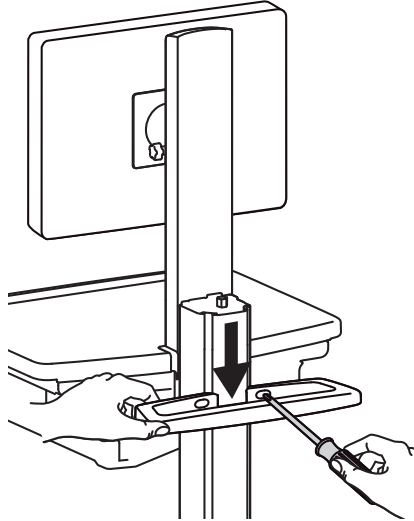

# c

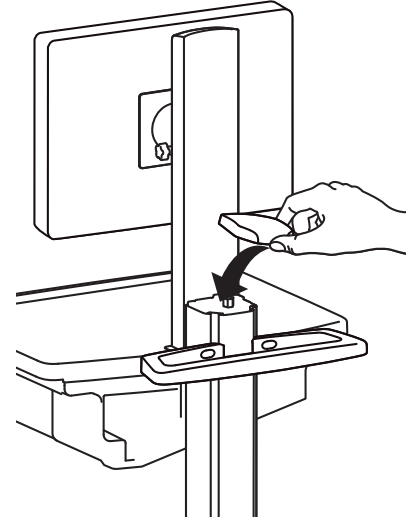

# d

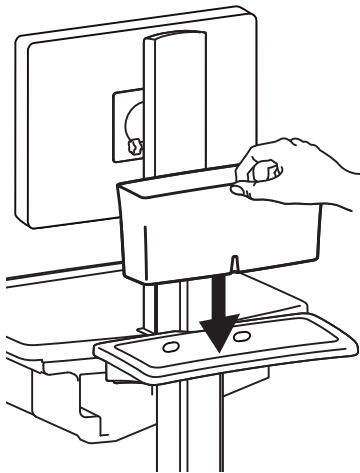

# e

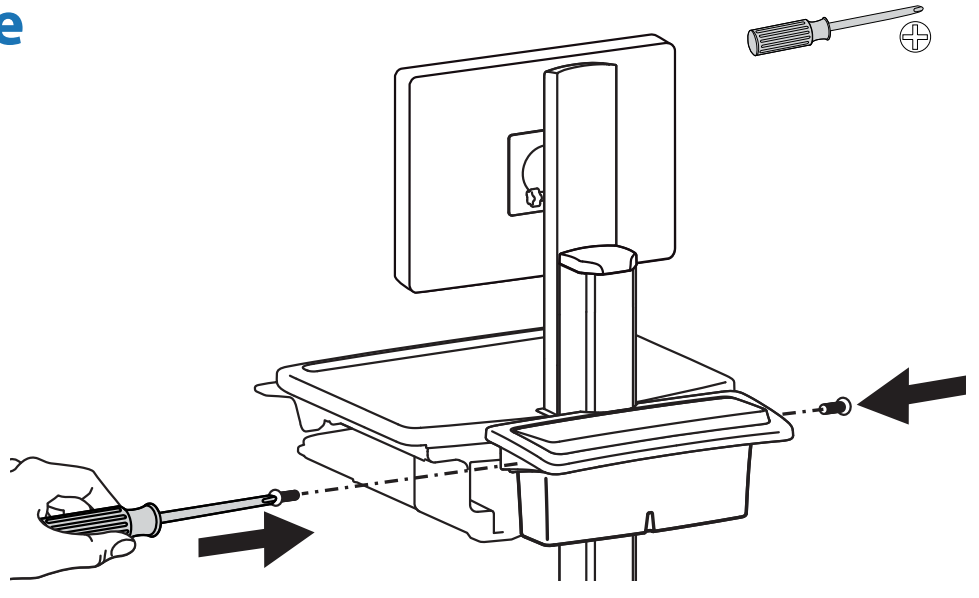

To access battery compartment, remove CPU.  
 Para acceder al compartimento de las baterías, retire la CPU.  
 Pour accéder au compartiment des piles, retirer l'unité centrale.  
 Um an das Akkufach zu gelangen, entfernen Sie die CPU.  
 Verwijder de CPU om het batterijvak te bereiken.  
 Per accedere al vano batterie, rimuovere la CPU.  
 バッテリー収納部を開くには、CPUを取り外します。  
 卸下 CPU，打开电池仓。  
 배터리함에 접근하려면 CPU를 제거하십시오.

# a

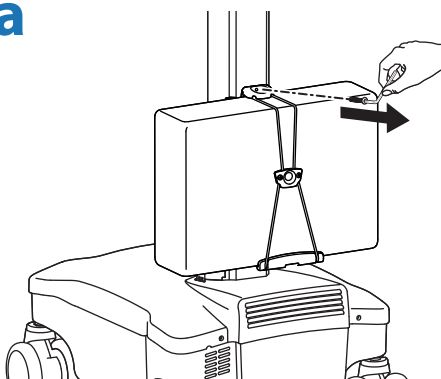

# b

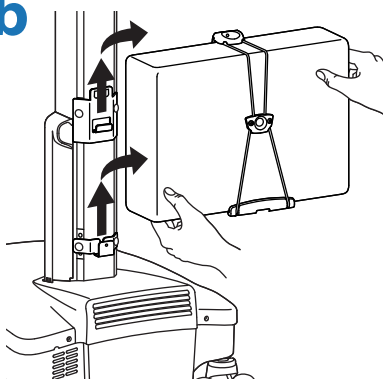

# c

